



CHANNEL S

With its elegant appearance and highest lighting quality, CHANNEL S ensures the best ambiance in any room. The versatile range of three optics and different mounting types offers great flexibility in lighting design and enables excellent lighting in the office and adjacent zones. CHANNEL S is extremely adaptable and impresses with a planning accuracy of 5 cm from the standard. CHANNEL S provides the best light in any environment.

FEATURES

"S" as in slim, aesthetic design in extremely compact dimensions of 65 x 60 mm

Available with integrated RUN Diffuser or office-compatible RUN+ Diffuser for continuous, seamless lines of light allowing precise planning up to 24 m length

Channel S Boost Office: very aesthetic louvre optics optimized for LED, particularly efficient, planning according to EN 12464-1, up to 3600 lm / 1,2 m

Economical overall solution featuring maximum ergonomics for the user

Visually perfect transition from profile to diffuser without gasket

For recessed installation in ceilings or walls with cover frame. Order accessories separately (for recessed installation without cover frame, the surface-mounted ceiling luminaire and the corresponding accessories are to be used)

TECHNICAL DATA

Luminous flux of luminaire	720 lm-4100 lm
Colour temperature	3000 K, 4000 K, 2700 K–6500 K
Colour Rendering Index [CRI]	Ra >80
Maintained luminous flux	L80 [B10] 50'000 h
Glare value	Up to UGR < 19
Protection class	I
Ingress Protection	IP20, optional IP40 up to IP54
Photobiological safety	Risk group 0, no risk

SPECIFICATIONS

100% direct light emission

End faces feature expansion compensation, generating a visually seamless, flush-mounted diffuser effect

Support profile and ends (visible part) in natural anodised aluminium

No visible screws

Colour temperature can be adjusted individually with the Tunable White technology

LED batten luminaire replaceable on site

Dimmable digital DALI

Operating unit integrated

Also available as system with cover frame

Also available ceiling and wall mounted luminaires as well as system without cover frame

APPLICATION AREAS

Office & Education: offices, open-plan offices, staff training facilities, conference rooms, libraries, classrooms, circulation zones

Industry: working areas

Retail & Hospitality: checkout areas, shopping malls

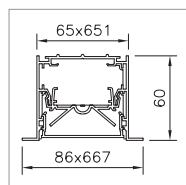
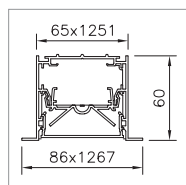
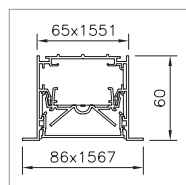
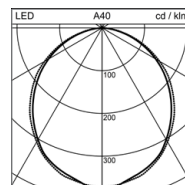

IP20 230V

1

2

3

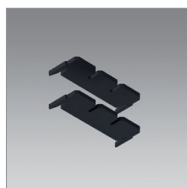
RECESSED CEILING LUMINAIRE CHANNEL S

Length	System power	Luminous flux of luminaire	Colour temperature	Notes	Ref. n°
667 mm	8.5 W	750 lm	4000 K		1 2003.3675
667 mm	8.5 W	720 lm	3000 K		1 2003.3672
667 mm	13 W	1100 lm	4000 K		1 2003.3681
667 mm	13 W	1060 lm	3000 K		1 2003.3678
667 mm	16 W	1360 lm	4000 K		1 2003.3687
667 mm	16 W	1300 lm	3000 K		1 2003.3684
667 mm	16 W	1360 lm	4000 K	IP 54	1 2005.4915
667 mm	16 W	1300 lm	3000 K	IP 54	1 2005.4912
1267 mm	14 W	1500 lm	4000 K		2 2003.3676
1267 mm	14 W	1440 lm	3000 K		2 2003.3673
1267 mm	23 W	2200 lm	4000 K		2 2003.3682
1267 mm	23 W	2100 lm	3000 K		2 2003.3679
1267 mm	23 W	2150 lm	2700-6500 K		2 2003.3691
1267 mm	23 W	2200 lm	4000 K	with emergency unit	2 2004.1679
1267 mm	23 W	2100 lm	3000 K	with emergency unit	2 2004.1677
1267 mm	23 W	2150 lm	2700-6500 K	with emergency unit	2 2004.1681
1267 mm	28 W	2700 lm	4000 K		2 2003.3688
1267 mm	28 W	2600 lm	3000 K		2 2003.3685
1267 mm	28 W	2700 lm	4000 K	IP 54	2 2005.4916
1267 mm	28 W	2600 lm	3000 K	IP 54	2 2005.4913
1567 mm	17 W	1880 lm	4000 K		3 2003.3677
1567 mm	17 W	1800 lm	3000 K		3 2003.3674
1567 mm	27 W	2750 lm	4000 K		3 2003.3683
1567 mm	27 W	2650 lm	3000 K		3 2003.3680
1567 mm	27 W	2700 lm	2700-6500 K		3 2003.3692
1567 mm	27 W	2750 lm	4000 K	with emergency unit	3 2004.1680
1567 mm	27 W	2650 lm	3000 K	with emergency unit	3 2004.1678
1567 mm	27 W	2700 lm	2700-6500 K	with emergency unit	3 2004.1682
1567 mm	34 W	3400 lm	4000 K		3 2003.3689
1567 mm	34 W	3250 lm	3000 K		3 2003.3686
1567 mm	34 W	3400 lm	4000 K	IP 54	3 2005.4918
1567 mm	34 W	3250 lm	3000 K	IP 54	3 2005.4914



GASKET KIT CHANNEL S

IP40 in combination with RUN and RUN+ diffusers in one piece for single luminaire and system

Notes	Ref. n°
	2004.6603

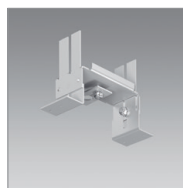

MOUNTING KIT CHANNEL S

for the mounting of support profiles with or without trim, for 1 – 30 mm false ceilings, recommended: all 1.5 m

Notes	Ref. n°
	2003.1609

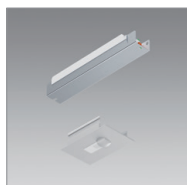

SENSOR MODULE SINGLE LUMINAIRE

Notes	Ref. n°
Stand-alone sensor for brightness control and presence detection, incl. control unit for luminaires up to 1500 mm	2004.7089
Remote control Channel S	2004.8332