



## PURELITE SLIM D

PURELITE SLIM is something to admire before it has even been turned on. The slimmest and thinnest luminaire in the industry, it is a feat of imagination and innovation. But then a switch is flicked. And PURELITE SLIM becomes a sleek strip of pure, uninterrupted, exceptional light. Although its design is hard to comprehend, the luminaire itself is easy to install at every stage of a project. So, the possibilities are as wide as PURELITE SLIM is so elegantly thin.

### FEATURES

Shadow-free lines of light, incl. illumination of the ceiling, timeless design

Simple to integrate into the architecture thanks to its ultra-flat design: height of only 35 mm incl. control gear

Available with integrated RUN diffuser [PURELITE SLIM D] or office-compatible RUN+ diffuser [PURELITE SLIM]

Omnidirectional, with illumination of the ceiling, also available with direct lighting

Batten luminaire range with a 2.5 cm design from standard, enables wall-to-wall planning

### SPECIFICATIONS

Recessed ceiling, ceiling and wall mounting, pendant luminaire and channel lighting system

Extremely good homogeneous direct illumination and all-round illumination

support profiles made of natural anodised aluminium

Clip-in LED batten with integrated through-wiring for quick and easy mounting

LED batten luminaire replaceable on site

High luminous efficacy of up to 150 lm/W

### TECHNICAL DATA

Luminous flux of luminaire	1600-3100 lm, Office 2150 lm
Colour temperature	3000 K, 4000 K
Colour Rendering Index [CRI]	≥ 80
Maintained luminous flux	L80 75'000 h
Glare value	Up to UGR < 19 $L_{max} \geq 65^\circ \leq 3000 \text{ cd/m}^2$
Protection class	I
Ingress Protection	IP20
Photobiological safety	risk group 0, no risk

### APPLICATION AREAS

**Office & Education:** open-plan offices, individual offices, classrooms, meeting rooms, foyers and lobbies, circulation zones

**Retail & Hospitality:** hotels, restaurants

**Home & Living**



IP20 230V IK08  $\varnothing_{0.5m}$  850°C **A+**

# OVERVIEW OF PURELITE SLIM D SYSTEM

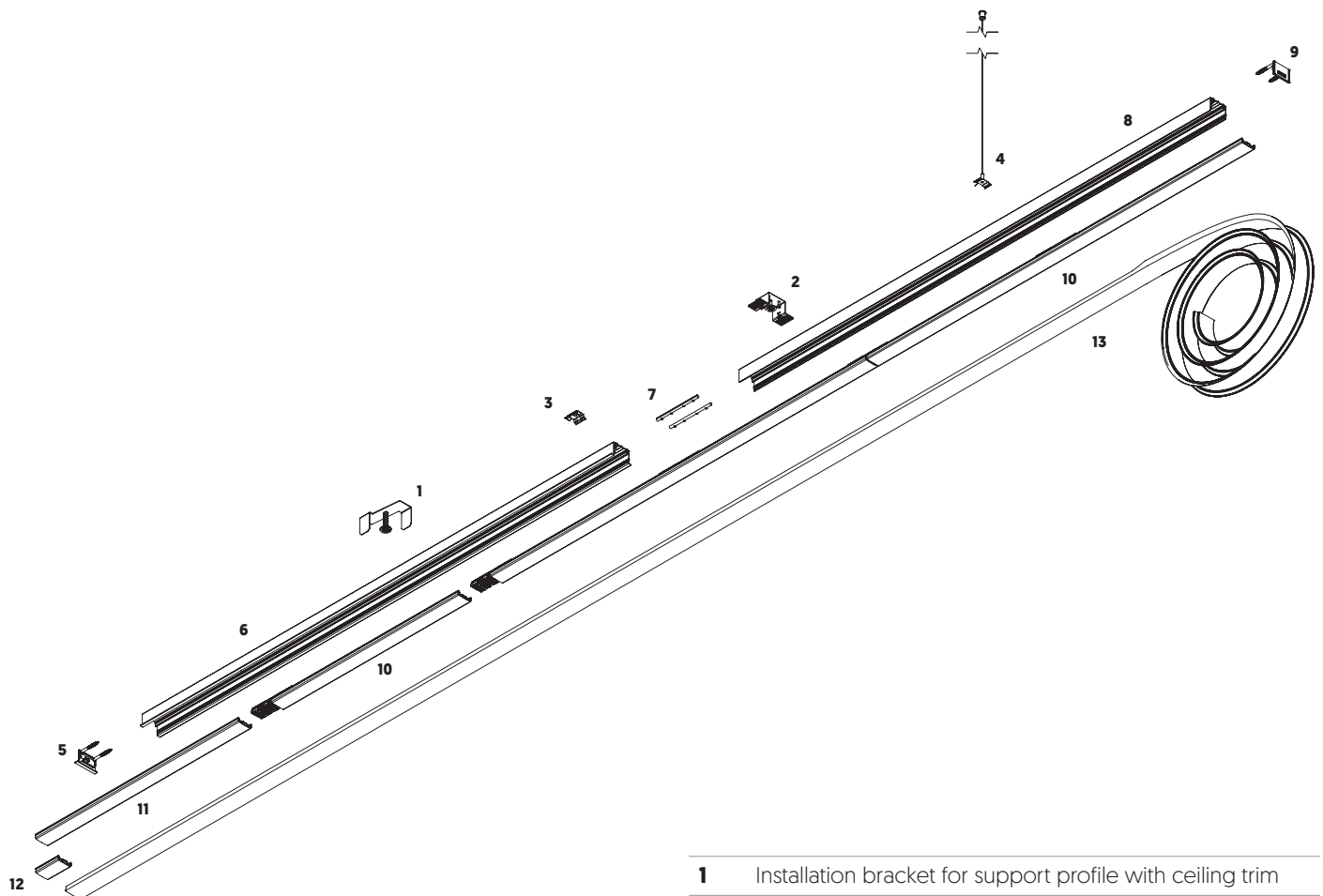

<b>1</b>	Installation bracket for support profile with ceiling trim
<b>2</b>	Installation bracket for support profile without ceiling trim
<b>3</b>	Mounting spring to compensate for uneven surfaces
<b>4</b>	Suspension set
<b>5</b>	End faces with ceiling trim
<b>6</b>	Support profile for channel lighting system with ceiling trim
<b>7</b>	Profile connector set
<b>8</b>	Support profile for channel lighting system without ceiling trim
<b>9</b>	End faces without ceiling trim
<b>10</b>	System batten Master
<b>11</b>	System batten Slave End 650 mm
<b>12</b>	System batten Slave End 75 mm
<b>13</b>	Rollable RUN diffuser

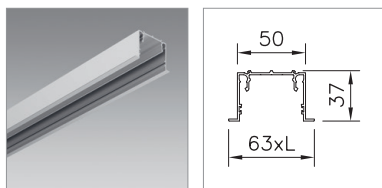

#### SUPPORT PROFILE FOR CHANNEL LIGHTING SYSTEM PURLITE SLIM D WITH CEILING TRIM

required length: 3 mm longer than the batten, please bear in mind the mounting direction, natural-colour anodised

Length	Ref. n°
2403 mm	2004.4790
3603 mm	2004.4791
4803 mm	2004.4792

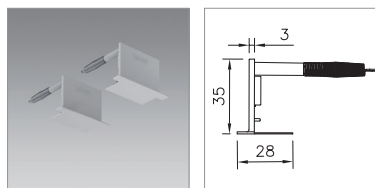

#### FRONT SIDE PURLITE SLIM D WITH CEILING TRIM

for support profile, 2 pieces, thickness 3 mm, synthetic material metallic silver, no visible screws, provide 2 mm empty profile per end face

Notes	Ref. n°
	2004.4078

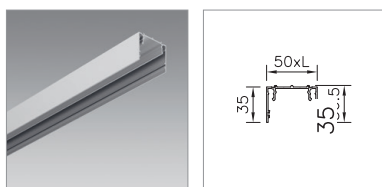

#### SUPPORT PROFILE FOR CHANNEL LIGHTING SYSTEM PURLITE SLIM D WITHOUT CEILING TRIM

required length: 3 mm longer than the batten, please bear in mind the mounting direction, natural-colour anodised

Length	Ref. n°
2403 mm	2004.4784
3603 mm	2004.4785
4803 mm	2004.4786

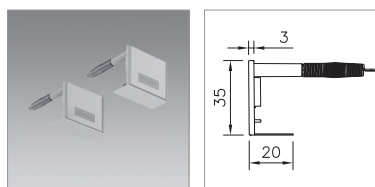

#### FRONT SIDE PURLITE SLIM D WITHOUT CEILING TRIM

for support profile, 2 pieces, thickness 3 mm, synthetic material metallic silver, no visible screws, provide 2 mm empty profile per end face

Notes	Ref. n°
	2004.4077



#### INFEED KIT PURLITE SLIM D

Including splint washer and tool for removing the batten and the diffuser from the support profile

Notes	Ref. n°
	2004.4081

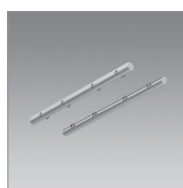

#### PROFILE CONNECTOR SET PURLITE SLIM

for all Purlite support profiles

Notes	Ref. n°
	2004.6466

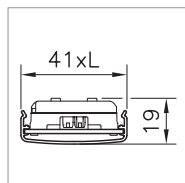

## BATTEN LUMINAIRE PURELITE SLIM D

### BATTEN LUMINAIRE MASTER

Master with control gear, 1 pc required per line of light, mount at the start of the line, incl. pre-installed connector to the next module, can be extended with a master or once with a slave.

Batten luminaires of the same type provide the same impression of brightness regardless of their length. Therefore, only batten luminaires of the same type should be applied together in one system, i.e. only xHE or only HE or only HPE.

Luminous flux of luminaire per 1,2 m for xHE 1860 lm, for HE 1860 lm and for HPE 2300 (each at 4000K).

System power	Length	Notes	Colour temperature	Light control	Ref. n°
9 W	600 mm	xHE	3000 K	DALI	2004.5183
10 W	600 mm	HE	3000 K	DALI	2004.5187
12 W	600 mm	HPE	3000 K	DALI	2005.2382
15 W	1200 mm	xHE	3000 K	DALI	2004.5184
17 W	1200 mm	HE	3000 K	DALI	2004.5188
21 W	1200 mm	HPE	3000 K	DALI	2005.2383
18 W	1500 mm	xHE	3000 K	DALI	2004.5185
21 W	1500 mm	HE	3000 K	DALI	2004.5189
26 W	1500 mm	HPE	3000 K	DALI	2005.2384
27 W	2400 mm	xHE	3000 K	DALI	2004.5186
31 W	2400 mm	HE	3000 K	DALI	2004.5190
39 W	2400 mm	HPE	3000 K	DALI	2005.2385
9 W	600 mm	xHE	4000 K	DALI	2004.5215
10 W	600 mm	HE	4000 K	DALI	2004.5219
12 W	600 mm	HPE	4000 K	DALI	2005.2386
15 W	1200 mm	xHE	4000 K	DALI	2004.5216
17 W	1200 mm	HE	4000 K	DALI	2004.5220
21 W	1200 mm	HPE	4000 K	DALI	2005.2387
18 W	1500 mm	xHE	4000 K	DALI	2004.5217
21 W	1500 mm	HE	4000 K	DALI	2004.5221
26 W	1500 mm	HPE	4000 K	DALI	2005.2388
27 W	2400 mm	xHE	4000 K	DALI	2004.5218
31 W	2400 mm	HE	4000 K	DALI	2004.5222
39 W	2400 mm	HPE	4000 K	DALI	2005.2389

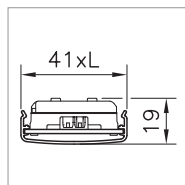

## BATTEN LUMINAIRE PURELITE SLIM D

### BATTEN LUMINAIRE SLAVE

End module Slave without control gear, only 1 piece per line required, installation at the end of the line, use after a Master module  
 System power and luminous flux dependent on the respective master module

Length	Notes	Colour temperature	Light control	Ref. n°
75 mm	xHE / HE / HPE	3000 K	DALI	2004.5214
100 mm	xHE / HE / HPE	3000 K	DALI	2004.5213
125 mm	xHE / HE / HPE	3000 K	DALI	2004.5212
150 mm	xHE / HE / HPE	3000 K	DALI	2004.5211
175 mm	xHE / HE / HPE	3000 K	DALI	2004.5210
200 mm	xHE / HE / HPE	3000 K	DALI	2004.5209
225 mm	xHE / HE / HPE	3000 K	DALI	2004.5208
250 mm	xHE / HE / HPE	3000 K	DALI	2004.5207
275 mm	xHE / HE / HPE	3000 K	DALI	2004.5206
300 mm	xHE / HE / HPE	3000 K	DALI	2004.5205
325 mm	xHE / HE / HPE	3000 K	DALI	2004.5204
350 mm	xHE / HE / HPE	3000 K	DALI	2004.5203
375 mm	xHE / HE / HPE	3000 K	DALI	2004.5202
400 mm	xHE / HE / HPE	3000 K	DALI	2004.5201
425 mm	xHE / HE / HPE	3000 K	DALI	2004.5200
450 mm	xHE / HE / HPE	3000 K	DALI	2004.5199
475 mm	xHE / HE / HPE	3000 K	DALI	2004.5198
500 mm	xHE / HE / HPE	3000 K	DALI	2004.5197
525 mm	xHE / HE / HPE	3000 K	DALI	2004.5196
550 mm	xHE / HE / HPE	3000 K	DALI	2004.5195
575 mm	xHE / HE / HPE	3000 K	DALI	2004.5194
600 mm	xHE / HE / HPE	3000 K	DALI	2004.5193
625 mm	xHE / HE / HPE	3000 K	DALI	2004.5192
650 mm	xHE / HE / HPE	3000 K	DALI	2004.5191
75 mm	xHE / HE / HPE	4000 K	DALI	2004.5246
100 mm	xHE / HE / HPE	4000 K	DALI	2004.5245
125 mm	xHE / HE / HPE	4000 K	DALI	2004.5244
150 mm	xHE / HE / HPE	4000 K	DALI	2004.5243
175 mm	xHE / HE / HPE	4000 K	DALI	2004.5242
200 mm	xHE / HE / HPE	4000 K	DALI	2004.5241
225 mm	xHE / HE / HPE	4000 K	DALI	2004.5240
250 mm	xHE / HE / HPE	4000 K	DALI	2004.5239
275 mm	xHE / HE / HPE	4000 K	DALI	2004.5238
300 mm	xHE / HE / HPE	4000 K	DALI	2004.5237
325 mm	xHE / HE / HPE	4000 K	DALI	2004.5236
350 mm	xHE / HE / HPE	4000 K	DALI	2004.5235
375 mm	xHE / HE / HPE	4000 K	DALI	2004.5234

400 mm	xHE / HE / HPE	4000 K	DALI	2004.5233
425 mm	xHE / HE / HPE	4000 K	DALI	2004.5232
450 mm	xHE / HE / HPE	4000 K	DALI	2004.5231
475 mm	xHE / HE / HPE	4000 K	DALI	2004.5230
500 mm	xHE / HE / HPE	4000 K	DALI	2004.5229
525 mm	xHE / HE / HPE	4000 K	DALI	2004.5228
550 mm	xHE / HE / HPE	4000 K	DALI	2004.5227
575 mm	xHE / HE / HPE	4000 K	DALI	2004.5226
600 mm	xHE / HE / HPE	4000 K	DALI	2004.5225
625 mm	xHE / HE / HPE	4000 K	DALI	2004.5224
650 mm	xHE / HE / HPE	4000 K	DALI	2004.5223

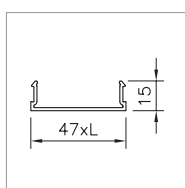

#### DIFFUSER PURELITE SLIM D

rollable up to 19,2 m, polymethyl methacrylate (PMMA)

Lenght	Ref. n°
2395 mm	2004.4809
3595 mm	2004.4810
4795 mm	2004.4811
9602 mm	2005.2185
19202 mm	2004.4812

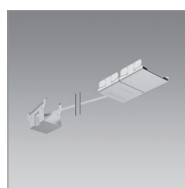

#### CUTTING AID PURELITE SLIM D DIFFUSER

can be used for at least 15 cuts

Notes	Ref. n°
	2005.2935

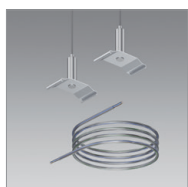

#### SUSPENSION SET PURELITE SLIM D

Length 1500 mm, with wire suspension and self-lock, load max. 20 kg, mounting recommendation: every 1.5 m

Notes	Ref. n°
2 wire cords, can be clipped into place, with 2 m power feed cable, transparent, with cable clamp	2004.4908
1 wire cord, can be clipped into place, adjustable	2004.4079

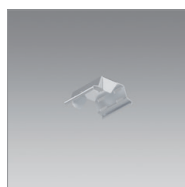

#### MOUNTING SPRING KIT PURELITE SLIM D

made of spring steel, to facilitate mounting the support profile on the ceiling, to compensate for uneven surfaces, as a placeholder for cable routing, Recommended: all 1.5 m

Notes	Ref. n°
1 piece	2004.1005



#### **MOUNTING SET PURELITE SLIM D**

for the mounting of trimless support profiles, for 1–30 mm false ceilings,  
 Recommended: all 1.5 m

<b>Notes</b>	<b>Ref. n°</b>
Mounting kit PURELITE SLIM D for support profile with ceiling trim	2004.4082
Mounting kit PURELITE SLIM D for support profile without ceiling trim	2004.4083